

FIXED SELECTIVE ACCESS barrier

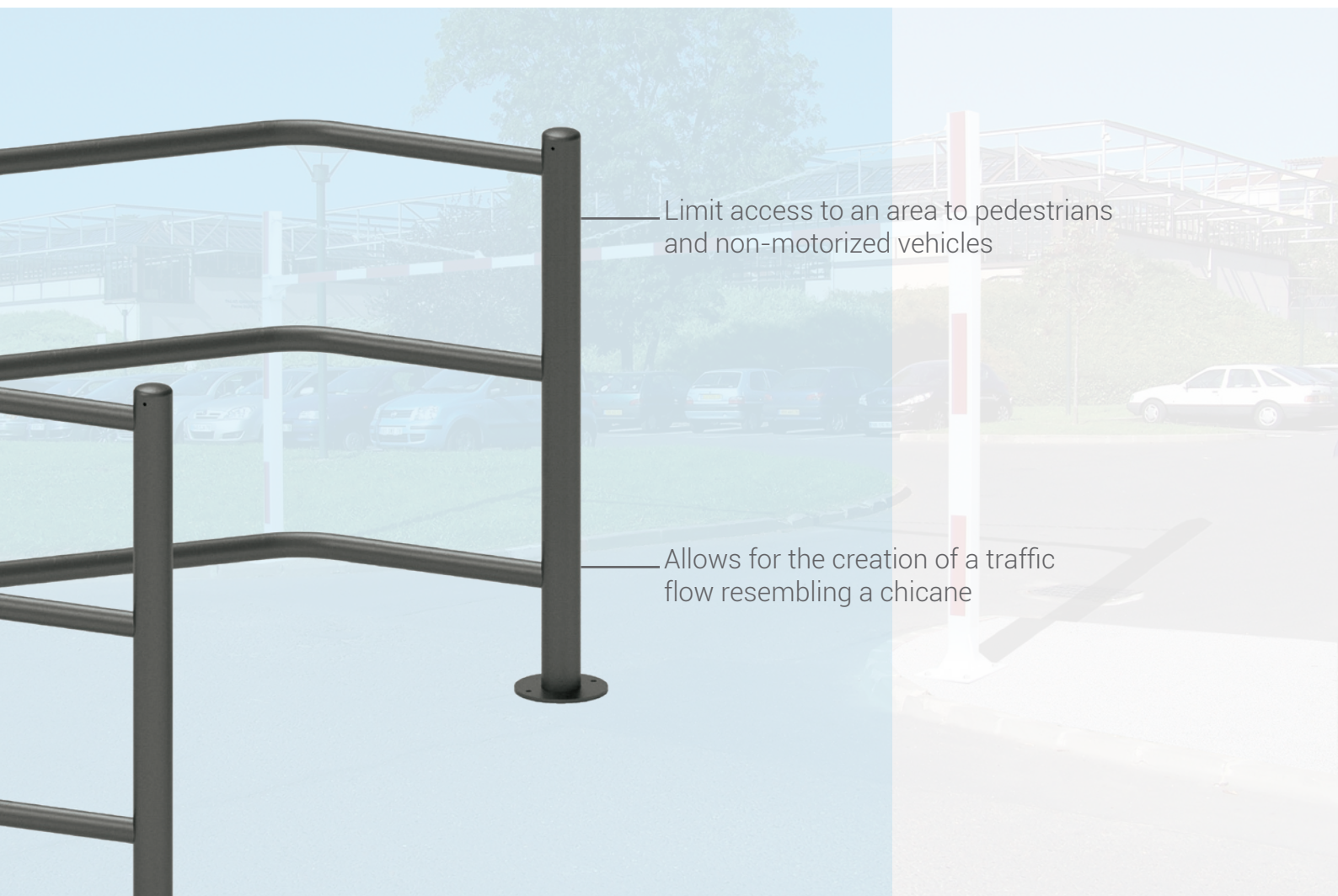

Limit access to an area to pedestrians and non-motorized vehicles

Allows for the creation of a traffic flow resembling a chicane



TECHNICAL CHARACTERISTICS

- > Dimensions:
depth 1926 x length 1200 x height 1090 mm
- > Structure: steel tube, Ø 76 mm with dome tops and Ø 50 mm steel tubes, 8 mm thick flat iron, fixing the 2 half frames with M12 screws and nuts
- > Installs in conjunction with a barrier

INSTALLATION

- > Installation on base plates Ø 180 mm



Code 2 x 203261 + 206081

OPTION

- > Swivel barrier 1400 mm

PRODUCT CODES

	Galvanised steel	Galvanised and painted
Fixed selective access barrier	203211	203261
Option		
Swivel barrier - Lg 1400 mm	203137	203138



Code 203261 + 203138

DRAWINGS

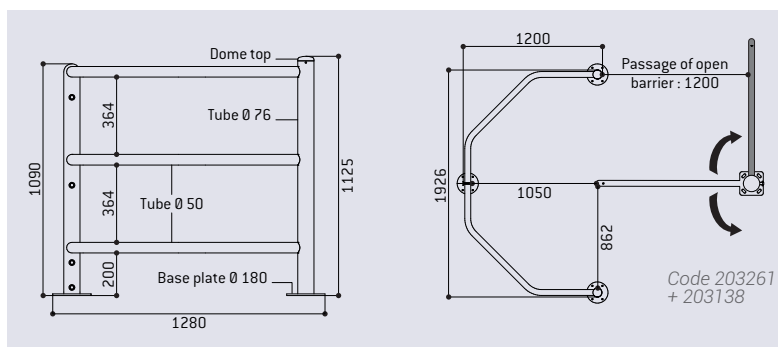

FINISH PAINTED

- > Galvanised and painted in our colours

